

Hero Interior Component

This document will explain how to use the “Hero Interior Component”:

1. Click the ‘**Edit**’ button, top right of the screen.

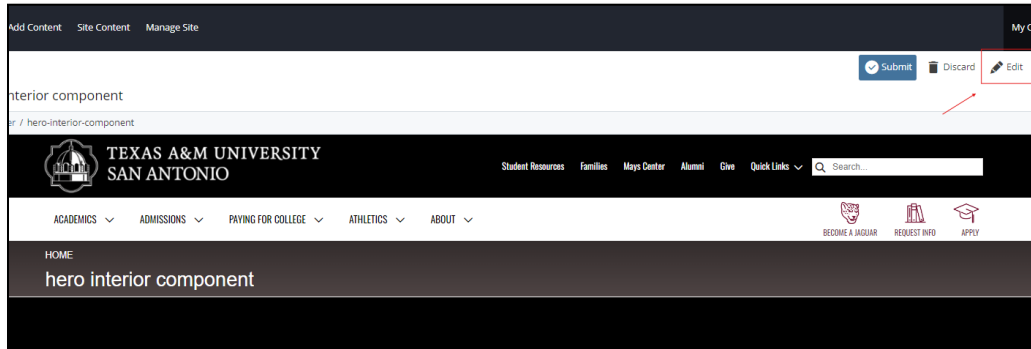

2. Navigate to “**Page Builder**” section, near the middle of the screen.

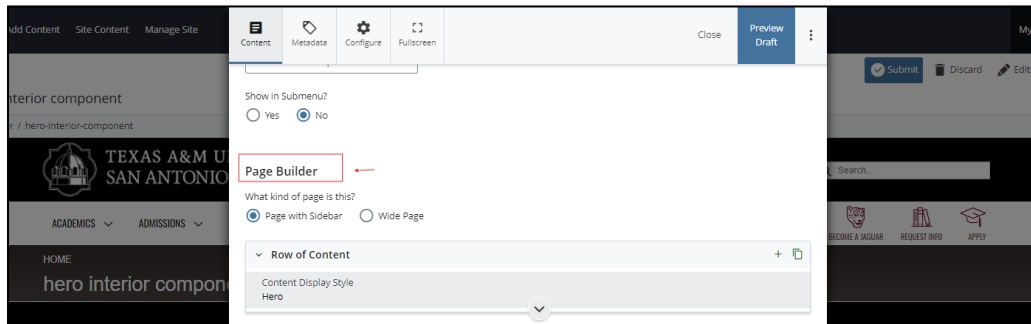

3. Open the **Row of Content** pane by clicking the carrot to the left of the **Row of Content** title.

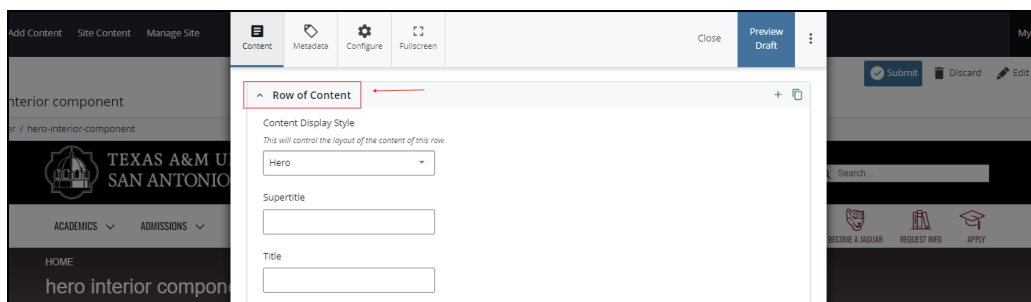

(Next Page)

4. Open the **Content Display Style** dropdown and select the **Hero Interior** option.

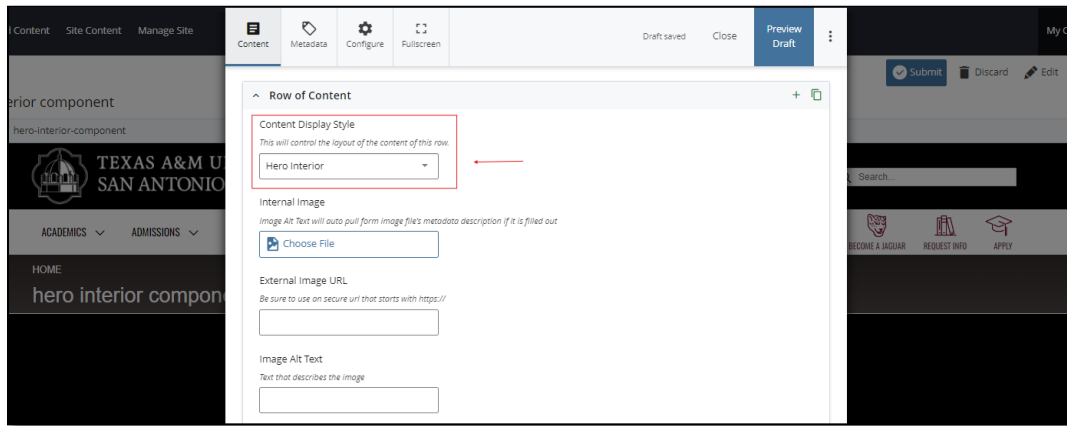

5. Adding an **Internal Image** is optional.

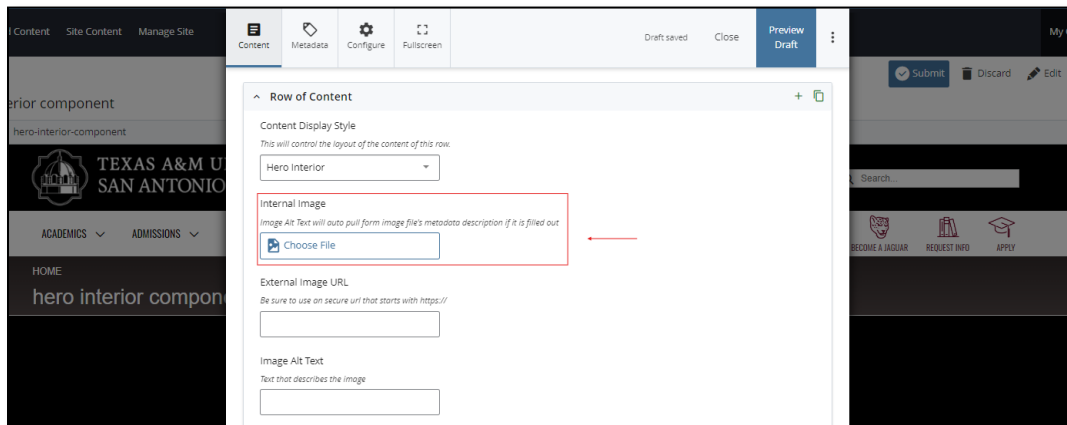

6. Adding an **External Image URL** is optional.
a. If an image is added, the **"Alt Text"** text box needs to be completed.

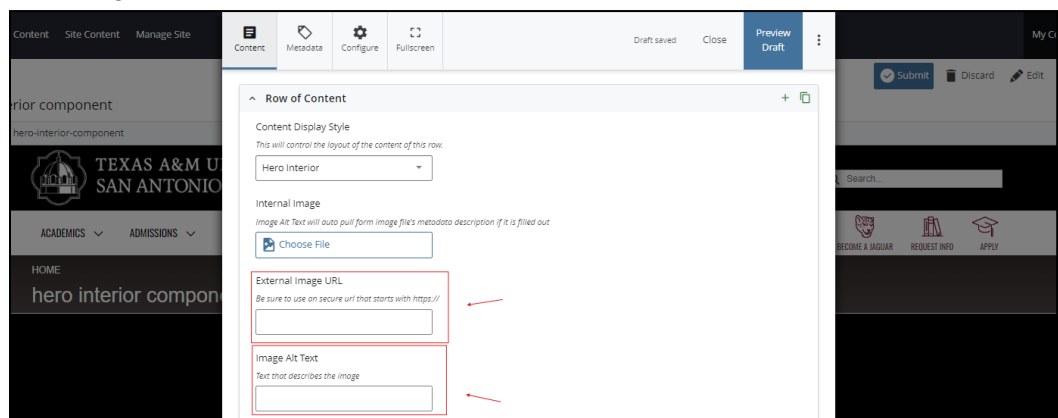

(Next Page)

7. After making edits, click on the **Preview Draft** button.

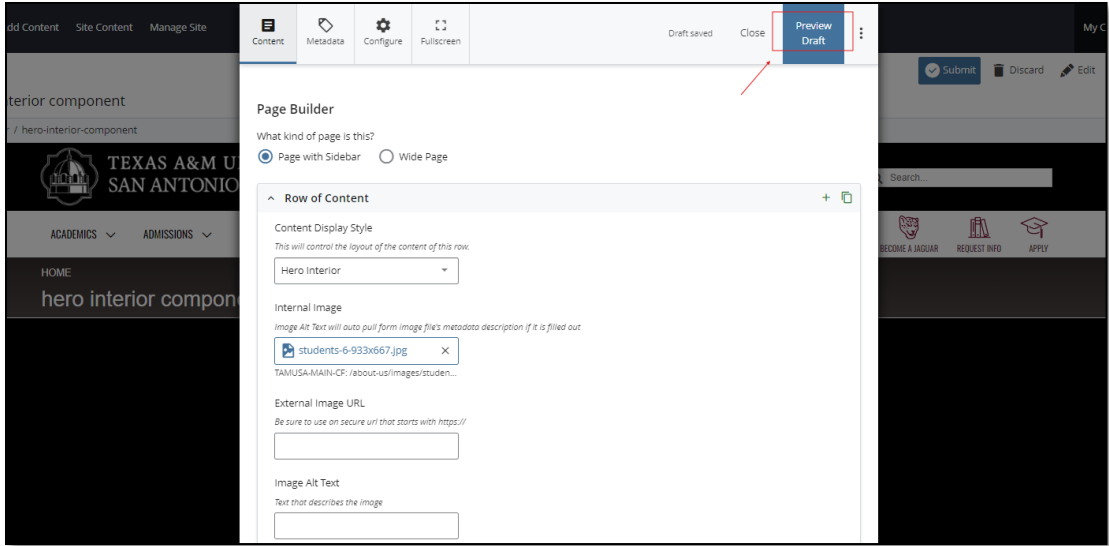

8. If you like what you've created click on the **Submit** button otherwise click on the **Edit** button if you'd like to continue to make changes.

